



# N 319 ECP

- Popular item  
- SKF Explorer

## Cylindrical roller bearings, single row

### Bearing data

[Tolerances](#),  
Normal (metric), P6, Normal (inch),  
[Radial internal clearance](#),  
cylindrical bore, tapered bore,  
[Axial internal clearance](#),  
NUP, NJ + HJ

### Bearing interfaces

[Seat tolerances for standard conditions](#),  
[Tolerances and resultant fit](#)

## Technical specification

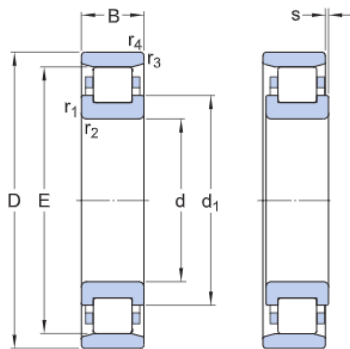

### DIMENSIONS

d	95 mm	Bore diameter
D	200 mm	Outside diameter
B	45 mm	Width
d1	≈132 mm	Shoulder diameter of inner ring
E	177.5 mm	Raceway diameter of outer ring
r1,2	min.3 mm	Chamfer dimension
r3,4	min.3 mm	Chamfer dimension
s	max.2.9 mm	Permissible axial displacement

### ABUTMENT DIMENSIONS

da	min.110 mm	Diameter of spacer sleeve
da	max.174 mm	Diameter of spacer sleeve
Da	min.181 mm	Diameter of housing abutment
Da	max.185 mm	Diameter of housing abutment
	max.2.5	Radius of

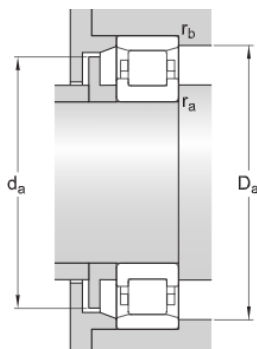

ra	mm	fillet
rb	max.2.5 mm	Radius of fillet

## CALCULATION DATA

Basic dynamic load rating	C	390 kN
Basic static load rating	C <sub>0</sub>	390 kN
Fatigue load limit	P <sub>u</sub>	46.5 kN
Reference speed		3 600 r/min
Limiting speed		4 300 r/min
Minimum load factor	k <sub>r</sub>	0.12
Limiting value	e	0.2
Axial load factor	Y	0.6

## MASS

Mass		6.23 kg
------	--	---------